

Head Office:
Dixon Kelley Estate Agents
1 Penn Court
Station Road, West Moors
Dorset. BH22 0JJ

DORSET PARK HOMES

DRAFT

www.dorsetparkhomes.com

Telephone: 01202 877511

63 The Avenue, Oaktree Park, Nr Ringwood, Hampshire. BH24 2RJ

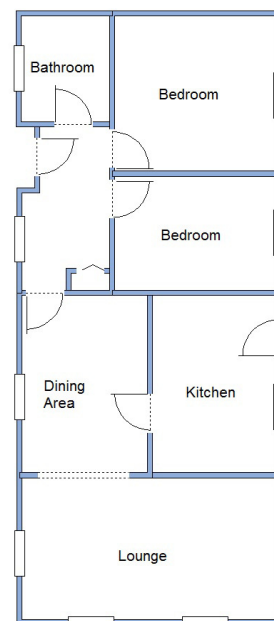

This drawing has been prepared for diagrammatic purpose only. Not to scale

2 Bedroom Park Home approx 40' x 17'

Accommodation & approximate room dimensions:

- Homeseeker Park Home approx 2006
- Entrance Hall: Cloaks cupboard.
- Dining Room: approx 11'8" x 8'0".
- Kitchen: approx 11'8" x 8'2". Good range of floor and wall units. Gas hob and cooker hood over (appliances untested). Cupboard housing Combination gas fired boiler (untested).
- Lounge: approx 16'5" x 9'4". Feature fireplace with electric fire fitted (untested).
- Bedroom 1: approx 10'8" x 10'4".
- Bathroom: White suite fitted. Shower over bath with shower fitted (untested).
- Bedroom 2: approx 10'8" x 7'6".
- PVCu Double-Glazing.
- Gas Central Heating (system untested).
- Parking on Plot
- Delightful Patio Garden with Large Shed
Rear Access with Double Gates
- Age Restriction 50+ Pets Considered
- Well maintained Residential Park with active Members Club. Located between Ringwood & Ferndown.

Close to the Forest



Pitch Fee: approx £200.88 per month
Subject to Annual Review
Council Tax Band: 'A'

Tenure: 1983 Mobile Homes Act Agreement

Price £165,000

VIEWING STRICTLY BY APPOINTMENT WITH THE VENDOR'S AGENT Dorset Park Homes 01202 877511

IMPORTANT NOTE: These particulars are believed to be correct but their accuracy is not guaranteed. They do not form part of any contract. Nothing in these particulars shall be deemed to be a statement that the property is in good structural condition or otherwise, nor that any of the services, appliances, equipment or facilities are in good working order or have been tested. Purchasers should satisfy themselves on such matters prior to purchase Ref.W04558

The recommended specialist in Park Home sales
Proprietor: Simon Dixon

